

PRODUCT FACT SHEET

Occupancy sensor

(Sony sensor XT-0000)

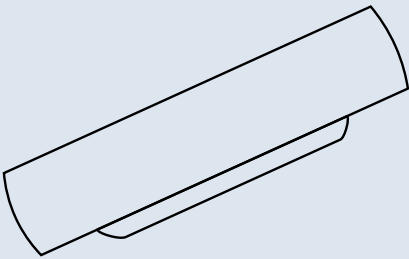

Description

Installed inside rooms, under desks, and near door frames to detect occupancy.

Product benefits

Sony’s wireless occupancy sensors for rooms, desks, and door frames can detect in true real time if a workspace is in use, from the moment a person sits down at a desk or enters a room. The sensors automatically update information about workspace availability across every Nimway interface. This lets employees find currently available spaces and helps your company understand your office space usage in fine detail.

Nimway occupancy sensors rarely, if ever, need to be replaced thanks to a guaranteed battery life of 10+ years. They are designed in Sweden and manufactured by Sony in the United Kingdom to the highest quality standards. This includes standards for environmental responsibility for the choice of materials and manufacturing process.

PARAMETER	SPECIFICATION
Power supply	Battery powered (10+ year guarantee)
Radio frequency	Sub 1 GHz ISM Bands*
Radio maximum output power	Less than +14 dBm
Radio features	LBT (Listen Before Talk) AFA (Automatic Frequency Agility)
Radio indoor range	~60 m
Target environment	0-40 °C
Weight	~60 g
Dimensions (L x W x H)	122 x 28 x 30 mm
Shipping	20 sensors per box 260 x 230 x 160 mm, 1.68 kg

\* Specific ISM Bands per region: India (865 MHz), EU (868 MHz),  
US and CAN (915 MHz), Singapore (920 MHz), Japan (928 MHz)